

TORNADO

Model
PB-300T



Thanks for Choosing Tornado
Personal Blender

ELARABY



19319

www.elarabygroup.com



Tornado

This appliance is intended to be used in household and similar applications such as:

- staff kitchen areas in shops, offices and other working environments.
- farm houses.
- by clients in hotels, motels and other residential type environments.
- bed and breakfast type environments. out of reach of children.

Important Safeguards

1. This appliance is intended for household only.
2. Before you operate this product, Please ensure you read the instruction manual and keep it .
3. This product is strictly prohibited operating without load or overload.
4. Do not use power other than AC 220V, or there is danger of electric shock or fire.
5. Please use the socket above 6A for single use. If you share the socket with other electrical appliances, the wiring part of the socket may cause abnormal heat and fire.
6. Hold the power cord plug by hand, and pull the power cord plug out of the plug socket smoothly.
7. Do not use the hard thing to crap the machine.
8. Unplug from outlet when not in use, or else may occur electric shock, leakage, fire risk.
9. This product works continuously for 30 seconds and stops for one minute. During the operation, if the engine is overheated, it should be shut down for about 20 minutes to cool down for continue use.
10. Only after the cup and the knife seat are tightly screwed can be installed on the machine seat, and the knife seat and the cup can not be separately installed on the machine seat.
11. The cup and knife seat must be tightly screwed to avoid leakage and knife holder fall off when the product is working.
12. The ingredients should not exceed the upper limit of the capacity of the cup (MAX).
13. The product is provided with the overheating protection device, when serious overload operation or abnormal use of motor, the product will automatically stop to protect, after 30 minutes protection , if the product can not start, it need to be sent to the company maintenance repair outlets, do not disassemble itself.
14. If the product is stuck when using, please turn off the power immediately, unplug the power plug, remove the container as well as the material that jam the blade, and you continue to use it after the motor is cooled .
15. The appliance is not intended for use by person (including children) with reduced physical, sensory or mental capabilities.
16. Unplug from outlet when not in use, before putting on or taking off parts, and before cleaning.

Important Safeguards

17. The cutting edges of the blades are very sharp, when using and cleaning it must be carefully.
18. The product must be cleaned immediately after use.
19. The first-time to use will have a slight smoke or smell, it is a normal phenomenon, it will disappear after a period of time.
20. All parts of this product are not allowed to use more than 60° of hot water and microwave oven disinfection, to avoid heating deformation damage.

Description

- 1.Lip
- 2.Silicon ring
- 3.Juice Cup
- 4.Cup base silicon ring
- 5.Cup base
- 6.Body

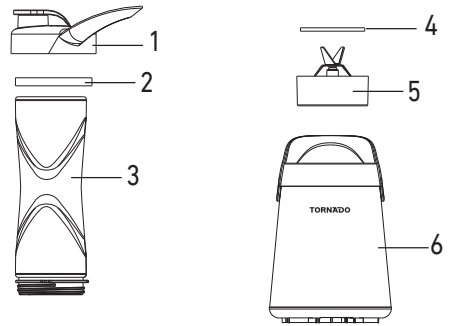

Characteristics

1. High speed motors at 23000 rpm, can smash the ingredients faster.
2. Motor with overheating shutdown protection, to ensure the motor is not burned.
3. Food contact areas are made of food grade safety materials.
4. The blade is made of SUS304 stainless steel.
5. Split cup and body design, easy to carry and wash at any time.

Instructions

1. Please read the instruction manual carefully and operate as required.
2. Take the base and accessories out of the packing box, remove the inner packing, clean the cup, lip, knife seat and sealing ring with the detergent. Rinse it with clean water and dry it.
3. Wipe the outside of the machine with a moist cloth.

Using Your Appliance

First step

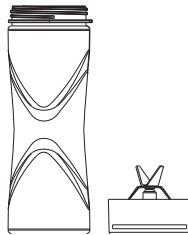

Second step



Third step

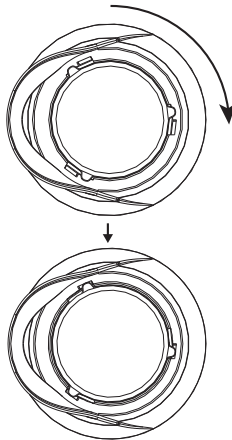

Fourth step

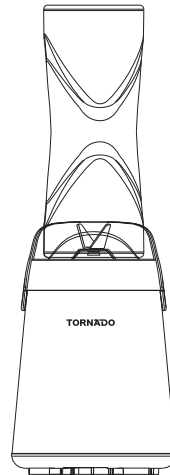

To lock / screw the juice cup, please press the cup down and turn it clockwise

Care And Maintenance

1. Unplug from outlet when not in use
2. Each assembly can be cleaned with water and sponge, please don't use hard steel wire to avoid damaging the surface;
3. When the cup base and cup are cleaned, place them in a ventilated place and dry them before packing;
4. Wipe the body with a moist cloth, do not immerse and wash it in water, to avoid leakage and broken;
5. When will not use long time, keep this appliance well ventilated at the aridity of place to prevent the motor of appliance is affected with damp.

Cleaning And Maintenance

CLEANING:

The detachable parts must be cleaned immediately after use, cleaning reference as the following:

1. First unplug the power plug, remove the cup from the machine and the knife seat out from the cup.
2. Rinse the detachable parts under running water, it also can clean in warm water with washing detergent.
3. After washing, rinse the detachable parts with clean water and dry thoroughly
4. Caution: The cutting edges of the blades are very sharp, cleaning it must be carefully.

CAUTION:

Never immerse the motor of the unit in water or any other liquid, use only a moist cloth to clean. Cleaning materials such as abrasives can not be used for cleaning and detachable parts can not be cleaned in the dishwasher.

MAINTENANCE:

- 1.This product should be used regularly to keep the motor dry.
- 2.When will not use long time, keep this appliance well ventilated at the aridity of place .

Technical Specifications

Model NO	PB-300T
Rated voltage	220-240V~50/60Hz
Rated power	300W
Max power	400W
Blender Bottle	600 ml

Question And Answer

Phenomenon	Reason Analysis	Solution
After the power on, start the switch, the product does not start or it start by pressing with hand and stop when leave	The cup does not screw into the body when start the switch	Repeatedly try to screw the cup still cannot work, please contact customer service
When start using the product several times, the motor still smells	Motor is with carbon brush, when operation it will have a slight paste flavor; Motor in new product will with rust oil, when it runs will produce a temperature that evaporates the smell of rust oil	If repeatedly used, the product will still smells, please contact customer service.
Shutdown when using	1. Low voltage 2. Motor temperature control protection.	1. Check if the voltage is too low 2. Stop using until 20-30 minutes
Abnormally loud or noisy	1. The cup and knife seat are not screwed 2. The product is not placed on a flat surface or the rubber feet get rid off 3. High voltage 4. The food is exceeded the upper of the cup	1. Screw the cup and the knife seat 2. Place the product on a flat surface or make every rubber feet install 3. Check whether the voltage is too high 4. Turn off the switch, unplug the appliance and remove the excess ingredients
The blade is jammed	The blade was wrapped around the ingredients or stuck	Turn off the switch in time, unplug the appliance, remove the ingredients and cut into small pieces
The cup leaks	1. The cup and the knife seat are not screwed 2. The cup is cracked 3. Sealing ring is not inside or sealing ring broken	1. Screw the cup and the knife seat 2. Replace the cup 3. Place or replace sealing ring and keep it smooth

Environment friendly disposal

You can help protect the environment!
Please remember to respect the local regulations:
hand in the non-working electrical equipments to an appropriate waste disposal center.

